

## CM-APANT-C-3

Combined Mount Version 3 for Cisco Access Points and Patch Antennas  
<https://wifighter.shop/en/CM-APANT-C-3>

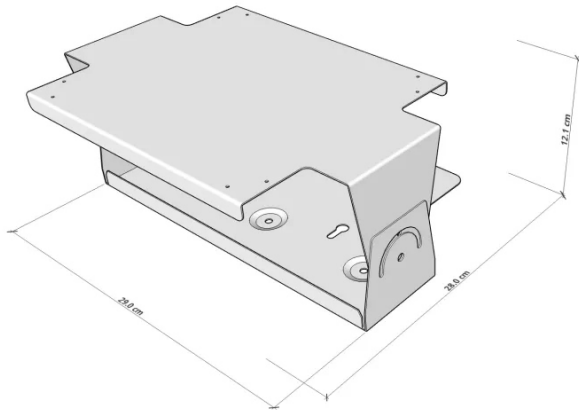

### Application

The combined mount for Cisco Access Points and patch antennas enables space-saving installation of Cisco Access Points with external patch antennas on walls or ceilings.

### Advantages

- Front section with antenna is adjustable ( $\pm 15^\circ$  to  $\pm 30^\circ$ )
- Mounting on wall or ceiling

### Compatibility

- Compatible APs: Cisco from AP1040 (approx. 2009)
- Compatible antennas: Cisco AIR-ANT2566P4W-R and antennas with the same mounting-hole dimensions

### Material, Color & Origin

- Powder-coated sheet metal (RAL 9010)
- Designed & made in Hamburg

### Quick Guide

- Fasten the mount to the wall or ceiling
- Insert the access point and secure it in place
- Install the antenna on the front plate and connect the cables
- Adjust the antenna angle